



LUXHOME
SEATING



2025

TABLE OF CONTENTS

Andover Collection	4
Andover Sofa & Loveseat	5
Andover Chair	6
Braxton Collection	7
Braxton Recliner w/Power Option	7
Brooklyn Collection	8
Brooklyn Sofa	9
Brooklyn Loveseat	10
Brooklyn Chair & 26" Footstool	11
Dreamland Collection	12
Dreamland Sofa & 2-Cushion Sofa	13
Dreamland Loveseat & Chair	14
Dreamland 26" Footstool	15
Ellington 1100 Collection	16
Ellington RAF Corner Sofa, Armless Loveseat & LAF Chaise Panel Arm	17
Ellington Sofa Panel Arm & Chair Panel Arm	18
Ellington 26" Footstool	19
Ellington 1100 Available Pieces	20
Ellington 1100 Sectional Examples	21
Ellington 1200 Collection	22
Ellington Sofa Sock Arm	23
Ellington Loveseat Sock Arm & Chair Sock Arm	24
Ellington 26" Footstool	25
Ellington 1200 Available Pieces	26
Ellington 1200 Sectional Examples	27
Ellington 1300 Collection	28
Ellington Sofa Track Arm	29
Ellington Loveseat Track Arm & Chair Track Arm	30
Ellington 26" Footstool	31
Ellington 1300 Available Pieces	32
Ellington 1300 Sectional Examples	33
Harmony Collection	34
Harmony WH 6-Piece Sectional	35
Harmony WH 5-Piece Sectional	36
Harmony WH Sofa Recliner	37
Harmony WH Loveseat Recliner	38
Harmony WH Recliner w/Power Option	39
Harmony Push Back Recliner	40
Harmony Rocker Recliner	41
Harmony Swivel Glider Recliner	42
Harmony Swivel Rocker Recliner	43
Hudson Collection	44
Hudson Recliner	44
Hudson Recliner w/Power Option	45
Remington Collection	46
Remington PWR Sofa Recliner w/Tilt Headrest	47
Remington PWR Loveseat Recliner w/Tilt Headrest	48
Remington PWR Chair Recliner w/Tilt Headrest	49
Serene Collection	50
Fully Modular, Q&A & Reversible Cushions	51
Serene 5-Seat Sectional Flat Arm & 5-Seat Sectional Tear Drop Arm	52
Serene Sofa Flat Arm & Sofa Tear Drop Arm	53
Serene Loveseat Flat Arm & Loveseat Tear Drop Arm	54
Serene Chair Flat Arm & Chair Tear Drop Arm	55
Serene Footstool	56
Serene Chaise	57
Serene Extra Seat Unit	58
Serene Available Pieces & Sectional Examples	59
Tatum Collection	60
Tatum Swivel Glider Recliner	60
Tatum Swivel Rocker Recliner	61
Tatum Rocker Recliner w/Power Option	62
Pillows & Nail Heads	63
Brown Maple & Oak Stain Colors	64
Fabrics & Leathers	65
Care & Cleaning Guide	66
Warranty	67

EXPERIENCE THE LUXURY OF QUALITY COMFORT

LuxHome Seating is a brand founded in 2023 by AJ's Furniture LLC with a focus on manufacturing fully upholstered living room seating with sleek cutting-edge designs for the wholesale market. Each item is built from scratch by our teams of skilled Amish craftsman and women. From hardwood frames with mortise and tenon joints, to drop-in coil spring seating, to high resilient foam covered with either a standard fabric, performance fabric or leather from the vast collection offered by Heartland Fabrics. Every piece is made for supreme comfort and longevity.

Please note: LuxHome works exclusively with Heartland Fabrics. The buyer is responsible for supplying LuxHome with any fabric or leather selected outside of Heartland Fabrics and there is no price deduction from LuxHome for this option. For pricing when using COM (Customer Own Material) please use our Standard Fabric price. See the fabric yardage and leather square footage requirement chart in the price list of all LuxHome products.

CONSTRUCTION THAT'S BUILT TO LAST

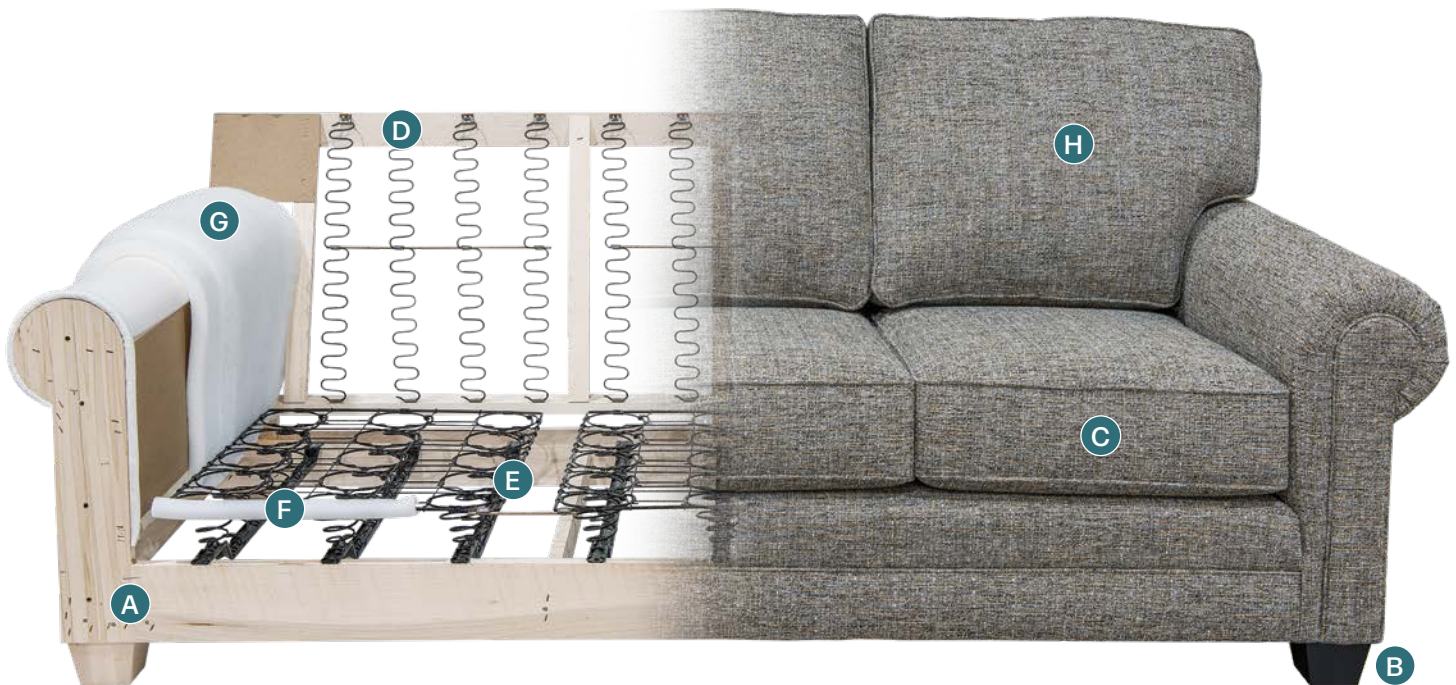

A Hardwood mortise tenon frames, with a lifetime warranty, ensure durability and support.



B Solid hardwood legs available in a large selection of stains.



C High Resilience 2.6 Density Seat Foam wrapped in polyester fibers inside a protective ticking for supreme comfort and longevity.

D Sinuous heavy gauge back springs provide proper support, comfort and durability.

E Drop-in coil springs, the coil springs in the Rigid Bar Construction are connected by a link-top fabrication, which spreads the weight load per spring more evenly than an 8 Way Hand-Tied unit. Every spring has been heat tempered (after forming) to insure a lifetime of consistent comfort. The springs in this fine furniture carry a lifetime warranty.

F An edge roll softens, shapes and adds lasting support to the front edge of the seat deck.

G Multiple layers of foam and fiber padding add comfort and support to arms.

H Channeled back cores filled with soft polyester fibers to allow for premium comfort and memory.



LUXHOME
SEATING

ANDOVER COLLECTION



FEATURES

Drop-in Coil Spring System
Pull Over Foam Backs
High Resilience 2.6 Density Seat Foam

CUSTOM OPTIONS

Softer Seat Foam (no upcharge)
Firmer Seat Foam (no upcharge)

WOOD ARMS

Available in All Wood Species



ANDOVER SOFA



ANDOVER LOVESEAT



*Shown in C16-23 Stone Fabric and
Quarter Sawn White Oak with Michael's Cherry*

DIMENSIONS	Width	Depth	Height	Inside Width	Seat Height	Seat Depth	Arm Height
AN103 Andover Sofa	81	34	36	70	19	21 ½	25
AN102 Andover Loveseat	58	34	36	47	19	21 ½	25

ANDOVER CHAIR



*Shown in Tumbleweed Leather
and Elm with FC 107 Harvest*

DIMENSIONS	Width	Depth	Height	Inside Width	Seat Height	Seat Depth	Arm Height
AN101 Andover Chair	32	34	36	21	19	21 ½	25

BRAXTON RECLINER W/POWER OPTION



BRAXTON FEATURES

- Push Back Recline
- Drop-in Coil Spring System
- Bustle Back
- High Resilience 2.6 Density Seat Foam
- Built-in Tapered Legs (non-removable)

CUSTOM OPTIONS

- Softer Seat Foam (no upcharge)
- Firmer Seat Foam (no upcharge)
- Battery Pack (upcharge, see price list)
- Power Option (upcharge, see price list)



WOOD LEGS

Available in Brown Maple or Oak (see page 64 for stain color options)



Shown in Kodiak Leather and Brown Maple with FC 11047 Ebony

DIMENSIONS	Width	Depth	Height	Inside Width	Seat Height	Seat Depth	Arm Height	Full Recline Length	Wall Clearance
505 BR Braxton Recliner	30	40	43	22	21	19	25	70	18



LUXHOME
SEATING

BROOKLYN COLLECTION



FEATURES

Drop-in Coil Spring System
Loose Fiber Filled Backs
High Resilience 2.6 Density Seat Foam

CUSTOM OPTIONS

Softer Seat Foam (no upcharge)
Firmer Seat Foam (no upcharge)

WOOD BASE & LEGS

Available in Brown Maple or Oak
(see page 64 for stain color options)



BROOKLYN SOFA



Shown in C16-20 Horizon Fabric and Brown Maple with FC 40592 Earthtone

DIMENSIONS

	Width	Depth	Height	Inside Width	Seat Height	Seat Depth	Arm Height
1603 BK Brooklyn Sofa	85	37	38	75	18 ½	21	26

BROOKLYN LOVESEAT



Shown in C16-20 Horizon Fabric and Brown Maple with FC 40592 Earthtone

DIMENSIONS

	Width	Depth	Height	Inside Width	Seat Height	Seat Depth	Arm Height
1602 BK Brooklyn Loveseat	60	37	38	50	18 ½	21	26

BROOKLYN CHAIR



BROOKLYN 26" FOOTSTOOL



Shown in Kodiak Leather and Brown Maple with FC 11047 Ebony

DIMENSIONS	Width	Depth	Height	Inside Width	Seat Height	Seat Depth	Arm Height
1601 BK Brooklyn Chair	35	37	38	25	18 ½	21	26
1626 BK Brooklyn 26" Footstool	26	24	16	-	-	-	-



LUXHOME
SEATING

DREAMLAND COLLECTION



FEATURES

Drop-in Coil Spring System
Loose Knife Edge Pillow Backs
High Resilience 2.6 Density Seat Foam
Removable Tapered Legs

CUSTOM OPTIONS

Firmer Seat Foam (no upcharge)

WOOD LEGS

Available in Brown Maple or Oak
(see page 64 for stain color options)

NOTE

Only Available in Fabric

*Sofa/Loveseat Shown in C16-61 Double Fabric, Chair/26" Footstool
Shown in C16-60 Chip Fabric and Brown Maple with FC 11047 Ebony*



DREAMLAND SOFA



DREAMLAND 2-CUSHION SOFA



Shown in C16-61 Double Fabric and Brown Maple with FC 11047 Ebony

DIMENSIONS	Width	Depth	Height	Inside Width	Seat Height	Seat Depth	Arm Height
1803 DL Dreamland Sofa	80	39	38	66	19 ½	22 ½	24
1804 DL Dreamland 2-Cushion Sofa	80	39	38	66	19 ½	22 ½	24
1805 DL Dreamland Large 2-Cushion Sofa (not shown)	89	39	38	75	19 ½	22 ½	24

DREAMLAND LOVESEAT



Shown in C16-61 Double Fabric and Brown Maple with FC 11047 Ebony

DREAMLAND CHAIR



Shown in C16-60 Chip Fabric and Brown Maple with FC 11047 Ebony

DIMENSIONS	Width	Depth	Height	Inside Width	Seat Height	Seat Depth	Arm Height
1802 DL Dreamland Loveseat	58	39	38	44	19 ½	22 ½	24
1801 DL Dreamland Chair	36	39	38	22	19 ½	22 ½	24

DREAMLAND 26" FOOTSTOOL



Shown in C16-60 Chip Fabric and Brown Maple with FC 11047 Ebony

DIMENSIONS

	Width	Depth	Height	Inside Width	Seat Height	Seat Depth	Arm Height
1826 DL Dreamland 26" Footstool	26	24	16	-	-	-	-



LUXHOME
SEATING

ELLINGTON 1100 COLLECTION



FEATURES

- Drop-in Coil Spring System
- Semi-Attached Fiber Filled Backs with Zipper
- High Resilience 2.6 Density Seat Foam
- Removable Tapered Legs
- Soft Edge Seating

CUSTOM OPTIONS

- Softer Seat Foam (no upcharge)
- Firmer Seat Foam (no upcharge)
- Foam Insert for Backs (upcharge, see price list)
- Nail Heads (upcharge, see page 63 for options)

WOOD LEGS

Available in Brown Maple or Oak
(see page 64 for stain color options)

*Shown in 23-13 Whitesand Fabric and
Brown Maple with FC 11047 Ebony*



ELLINGTON RAF CORNER SOFA, ARMLESS LOVESEAT & LAF CHAISE PANEL ARM



Shown in 23-13 Whitesand Fabric and Brown Maple with FC 11047 Ebony

DIMENSIONS

	Width	Depth	Height	Inside Width	Seat Height	Seat Depth	Arm Height
1104 EL Ellington RAF Chair Panel Arm	31	38	38	22	19	21	25
1105 EL Ellington RAF Loveseat Panel Arm	53	38	38	44	19	21	25
1106 EL Ellington RAF Sofa Panel Arm	75	38	38	66	19	21	25
1107 EL Ellington LAF Chair Panel Arm	31	38	38	22	19	21	25
1108 EL Ellington LAF Loveseat Panel Arm	53	38	38	44	19	21	25
1109 EL Ellington LAF Sofa Panel Arm	75	38	38	66	19	21	25
1110 EL Ellington RAF Chaise Panel Arm	31	67	38	22	19	51	25
1111 EL Ellington LAF Chaise Panel Arm <i>(shown)</i>	31	67	38	22	19	51	25
1112 EL Ellington RAF Corner Sofa Panel Arm <i>(shown)</i>	91	38	38	65	19	21	25
1113 EL Ellington LAF Corner Sofa Panel Arm	91	38	38	65	19	21	25
1114 EL Ellington Corner Seat	38	38	38	22	19	21	-
1115 EL Ellington Armless Chair	22	38	38	22	19	21	-
1116 EL Ellington Armless Loveseat <i>(shown)</i>	44	38	38	44	19	21	-
1117 EL Ellington Armless Sofa	66	38	38	66	19	21	-

ELLINGTON SOFA PANEL ARM



Shown in 23-13 Whitesand Fabric and Brown Maple with FC 11047 Ebony

ELLINGTON CHAIR PANEL ARM



Shown in Texas Leather and Brown Maple with FC 11047 Ebony

DIMENSIONS

	Width	Depth	Height	Inside Width	Seat Height	Seat Depth	Arm Height
1103 EL Ellington Sofa Panel Arm	84	38	38	66	19	21	25
1102 EL Ellington Loveseat Panel Arm <i>(not shown)</i>	62	38	38	44	19	21	25
1101 EL Ellington Chair Panel Arm	40	38	38	22	19	21	25

ELLINGTON 26" FOOTSTOOL



Shown in Rum Leather (left) and Texas Leather (above/right) and Brown Maple with FC 11047 Ebony

DIMENSIONS

	Width	Depth	Height	Inside Width	Seat Height	Seat Depth	Arm Height
1118 EL Ellington Chair 1/2 Panel Arm <i>(not shown)</i>	50	38	38	22	19	21	25
1126 EL Ellington 26" Footstool	26	24	16	-	-	-	-
1136 EL Ellington 36" Footstool <i>(not shown)</i>	36	24	16	-	-	-	-

ELLINGTON 1100 AVAILABLE PIECES

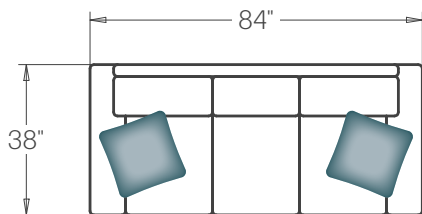

**Item #1103 EL
Sofa**

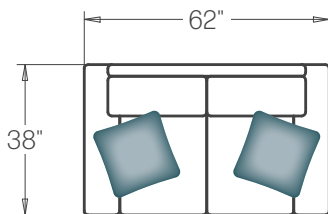

**Item #1102 EL
Loveseat**

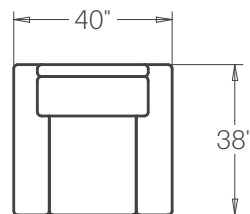

**Item #1101 EL
Chair**

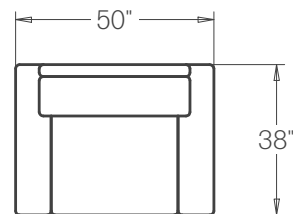

**Item #1118 EL
Chair 1/2**

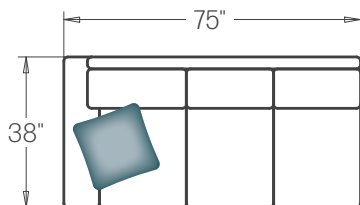

**Item #1109 EL
LAF Sofa**

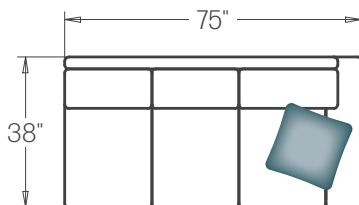

**Item #1106 EL
RAF Sofa**

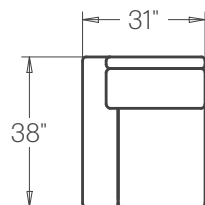

**Item #1107 EL
LAF Chair**

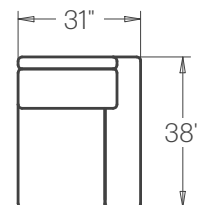

**Item #1104 EL
RAF Chair**

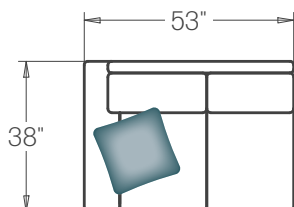

**Item #1108 EL
LAF Loveseat**

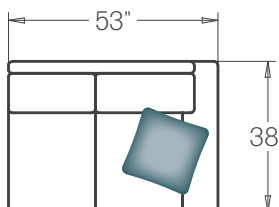

**Item #1105 EL
RAF Loveseat**

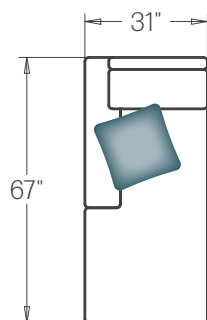

**Item #1111 EL
LAF Chaise**

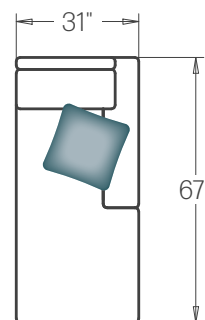

**Item #1110 EL
RAF Chaise**

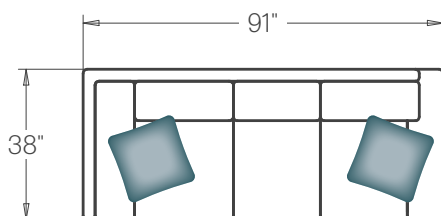

**Item #1112 EL
RAF Corner Sofa**

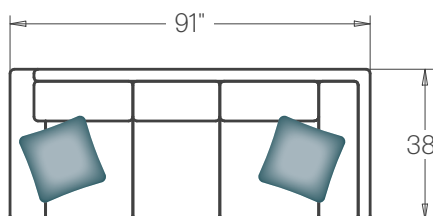

**Item #1113 EL
LAF Corner Sofa**

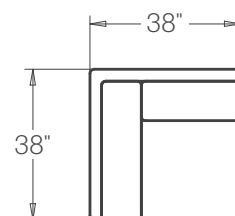

**Item #1114 EL
Corner Seat**

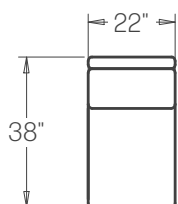

**Item #1115 EL
Armless Chair**

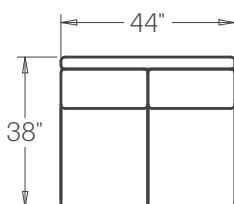

**Item #1116 EL
Armless Loveseat**

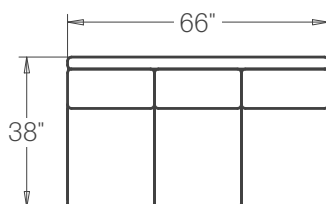

**Item #1117 EL
Armless Sofa**

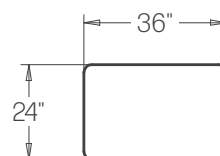

**Item #1136 EL
36" Footstool**

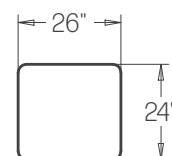

**Item #1126 EL
26" Footstool**

ELLINGTON 1100 SECTIONAL EXAMPLES

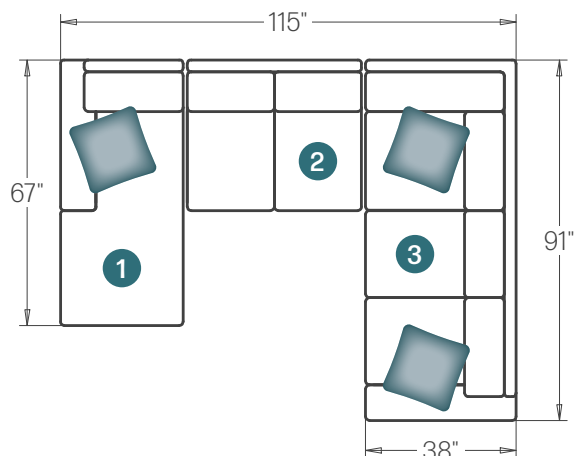

- 1 - Item #1111 EL LAF Chaise
- 2 - Item #1116 EL Armless Loveseat
- 3 - Item #1112 EL RAF Corner Sofa

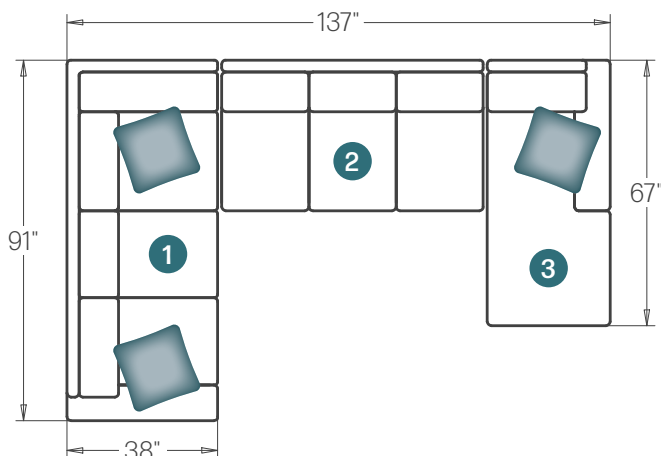

- 1 - Item #1113 EL LAF Corner Sofa
- 2 - Item #1117 EL Armless Sofa
- 3 - Item #1110 EL RAF Chaise

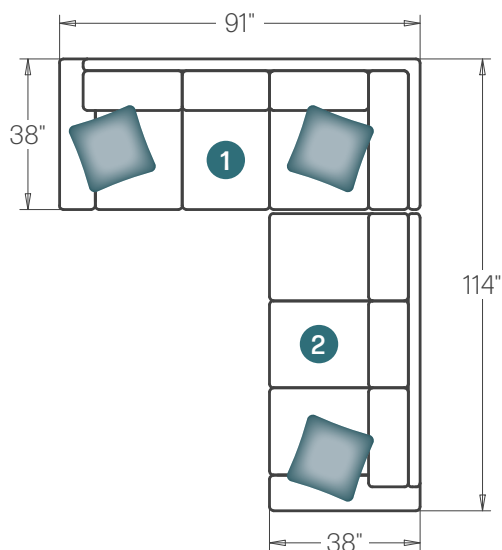

- 1 - Item #1113 EL LAF Corner Sofa
- 2 - Item #1106 EL RAF Sofa

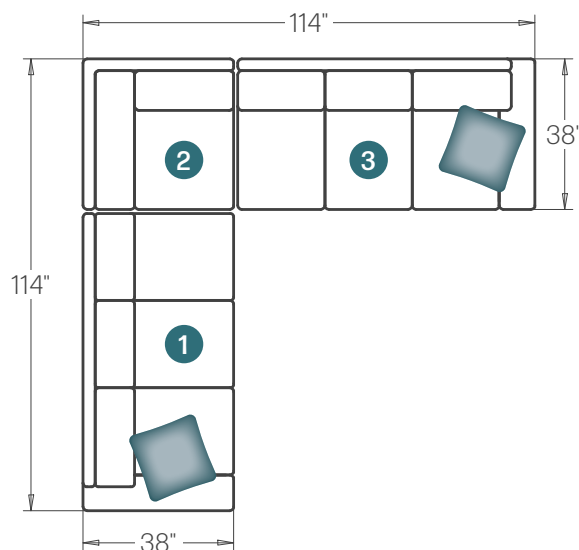

- 1 - Item #1109 EL LAF Sofa
- 2 - Item #1114 EL Corner Seat
- 3 - Item #1106 EL RAF Sofa

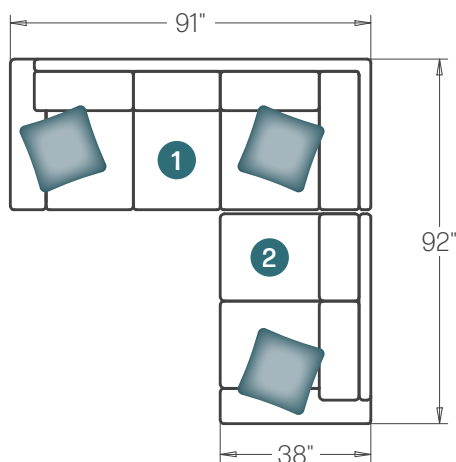

- 1 - Item #1113 EL LAF Corner Sofa
- 2 - Item #1108 EL LAF Loveseat

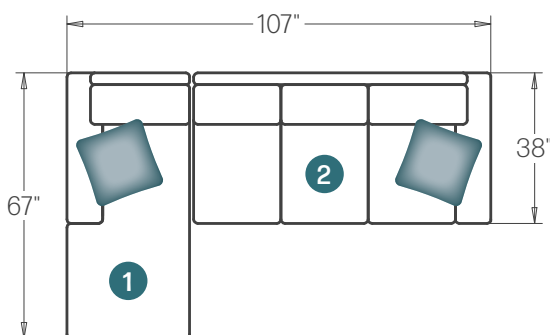

- 1 - Item #1111 EL LAF Chaise
- 2 - Item #1106 EL RAF Sofa



LUXHOME
SEATING

ELLINGTON 1200 COLLECTION



FEATURES

Drop-in Coil Spring System
Semi-Attached Fiber Filled Backs with Zipper
High Resilience 2.6 Density Seat Foam
Removable Tapered Legs
Soft Edge Seating

CUSTOM OPTIONS

Softer Seat Foam (no upcharge)
Firmer Seat Foam (no upcharge)
Foam Insert for Backs (upcharge, see price list)
Nail Heads (upcharge, see page 63 for options)

WOOD LEGS

Available in Brown Maple or Oak
(see page 64 for stain color options)



ELLINGTON SOFA SOCK ARM



Shown in R1-19 Shack Fabric and Brown Maple with FC 11047 Ebony

DIMENSIONS

	Width	Depth	Height	Inside Width	Seat Height	Seat Depth	Arm Height
1203 EL Ellington Sofa Sock Arm <i>(shown)</i>	84	38	38	66	19	21	25
1204 EL Ellington RAF Chair Sock Arm	31	38	38	22	19	21	25
1205 EL Ellington RAF Loveseat Sock Arm	53	38	38	44	19	21	25
1206 EL Ellington RAF Sofa Sock Arm	75	38	38	66	19	21	25
1207 EL Ellington LAF Chair Sock Arm	31	38	38	22	19	21	25
1208 EL Ellington LAF Loveseat Sock Arm	53	38	38	44	19	21	25
1209 EL Ellington LAF Sofa Sock Arm	75	38	38	66	19	21	25
1210 EL Ellington RAF Chaise Sock Arm	31	67	38	22	19	51	25
1211 EL Ellington LAF Chaise Sock Arm	31	67	38	22	19	51	25
1212 EL Ellington RAF Corner Sofa Sock Arm	91	38	38	65	19	21	25
1213 EL Ellington LAF Corner Sofa Sock Arm	91	38	38	65	19	21	25
1214 EL Ellington Corner Seat	38	38	38	22	19	21	-
1215 EL Ellington Armless Chair	22	38	38	22	19	21	-
1216 EL Ellington Armless Loveseat	44	38	38	44	19	21	-
1217 EL Ellington Armless Sofa	66	38	38	66	19	21	-

ELLINGTON LOVESEAT SOCK ARM



Shown in R1-19 Shack Fabric and Brown Maple with FC 11047 Ebony

ELLINGTON CHAIR SOCK ARM



Shown in Rum Leather and Brown Maple with FC 11047 Ebony

DIMENSIONS

	Width	Depth	Height	Inside Width	Seat Height	Seat Depth	Arm Height
1202 EL Ellington Loveseat Sock Arm	62	38	38	44	19	21	25
1201 EL Ellington Chair Sock Arm	40	38	38	22	19	21	25
1218 EL Ellington Chair 1/2 Sock Arm <i>(not shown)</i>	50	38	38	22	19	21	25

ELLINGTON 26" FOOTSTOOL



Shown in Rum Leather (left) and Texas Leather (above/right) and Brown Maple with FC 11047 Ebony

DIMENSIONS	Width	Depth	Height	Inside Width	Seat Height	Seat Depth	Arm Height
1126 EL Ellington 26" Footstool	26	24	16	-	-	-	-
1136 EL Ellington 36" Footstool (not shown)	36	24	16	-	-	-	-

ELLINGTON 1200 AVAILABLE PIECES

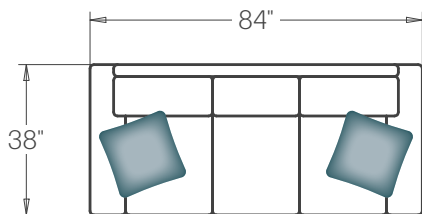

**Item #1203 EL
Sofa**

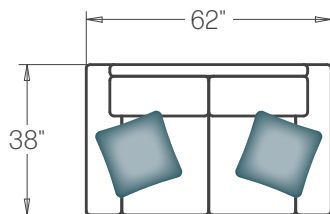

**Item #1202 EL
Loveseat**

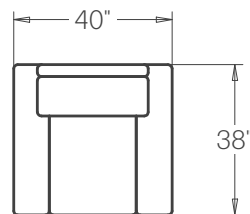

**Item #1201 EL
Chair**

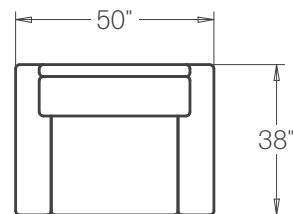

**Item #1218 EL
Chair 1/2**

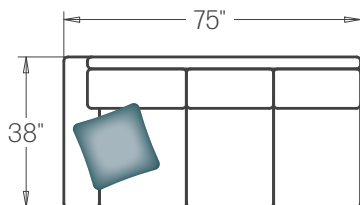

**Item #1209 EL
LAF Sofa**

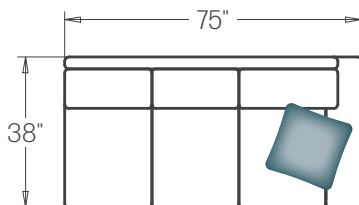

**Item #1206 EL
RAF Sofa**

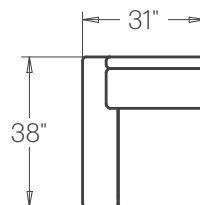

**Item #1207 EL
LAF Chair**

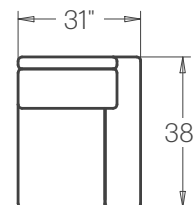

**Item #1204 EL
RAF Chair**

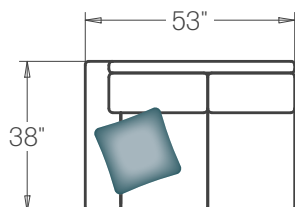

**Item #1208 EL
LAF Loveseat**

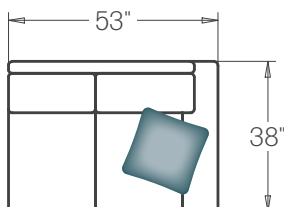

**Item #1205 EL
RAF Loveseat**

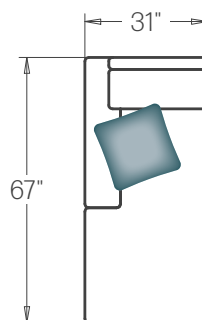

**Item #1211 EL
LAF Chaise**

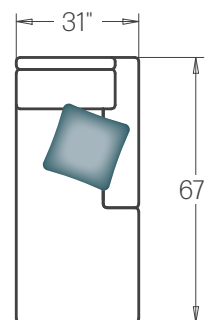

**Item #1210 EL
RAF Chaise**

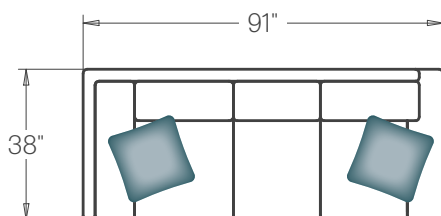

**Item #1212 EL
RAF Corner Sofa**

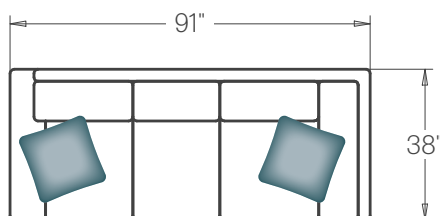

**Item #1213 EL
LAF Corner Sofa**

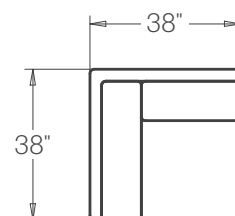

**Item #1214 EL
Corner Seat**

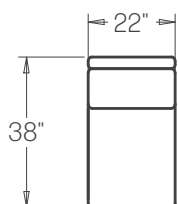

**Item #1215 EL
Armless Chair**

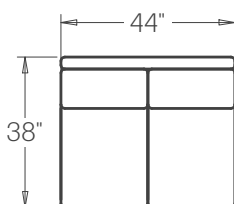

**Item #1216 EL
Armless Loveseat**

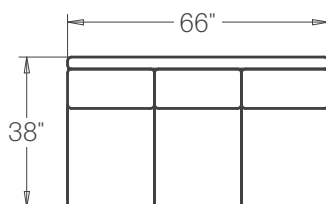

**Item #1217 EL
Armless Sofa**

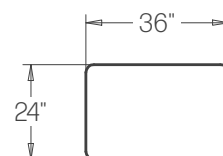

**Item #1136 EL
36" Footstool**

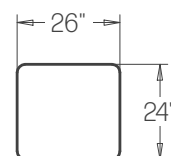

**Item #1126 EL
26" Footstool**

ELLINGTON 1200 SECTIONAL EXAMPLES

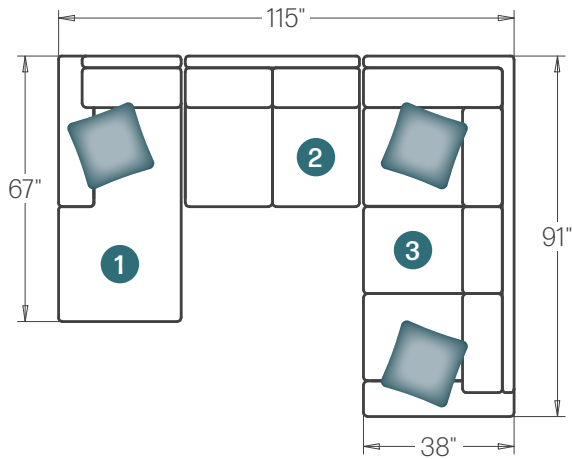

- 1 - Item #1211 EL LAF Chaise
- 2 - Item #1216 EL Armless Loveseat
- 3 - Item #1212 EL RAF Corner Sofa

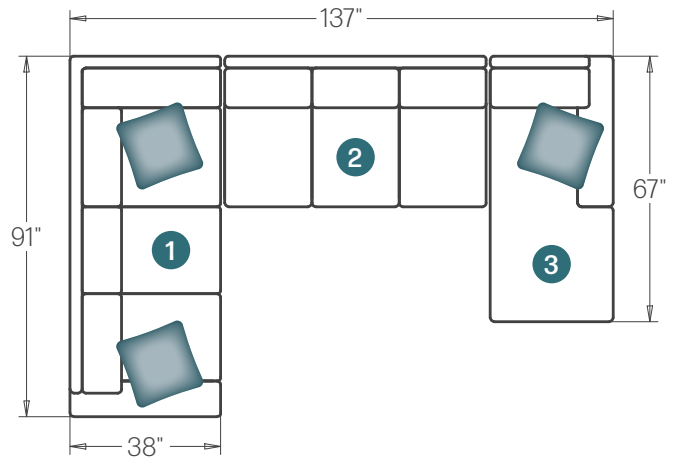

- 1 - Item #1213 EL LAF Corner Sofa
- 2 - Item #1217 EL Armless Sofa
- 3 - Item #1210 EL RAF Chaise

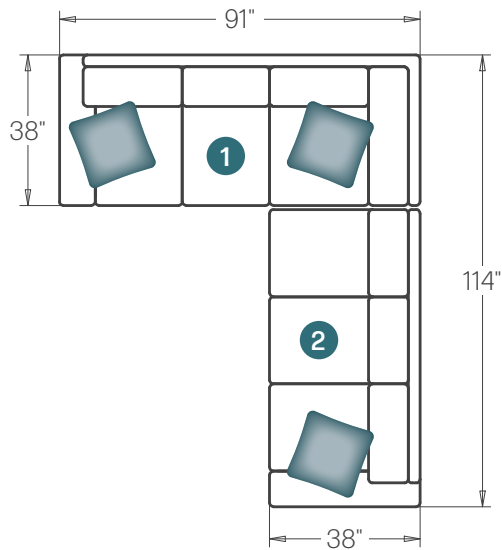

- 1 - Item #1213 EL LAF Corner Sofa
- 2 - Item #1206 EL RAF Sofa

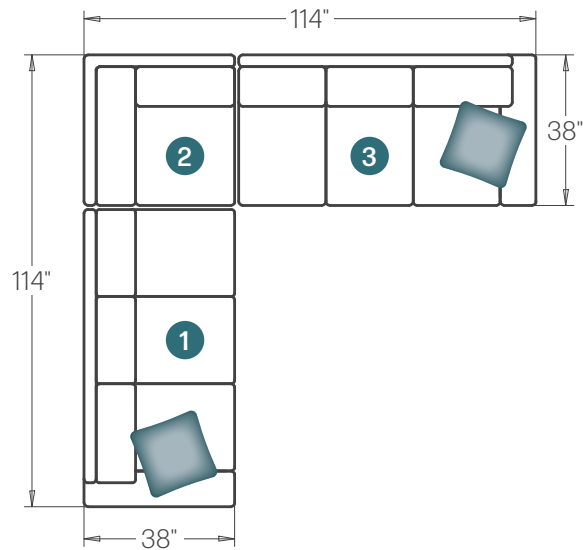

- 1 - Item #1209 EL LAF Sofa
- 2 - Item #1214 EL Corner Seat
- 3 - Item #1206 EL RAF Sofa

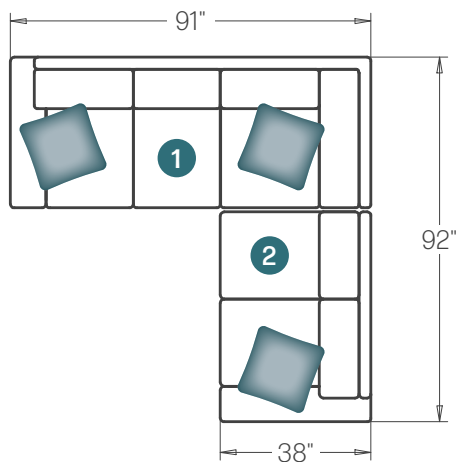

- 1 - Item #1213 EL LAF Corner Sofa
- 2 - Item #1208 EL LAF Loveseat

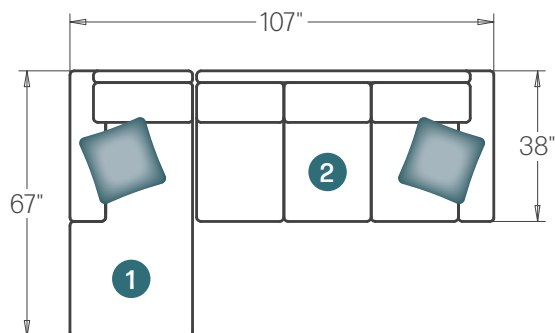

- 1 - Item #1211 EL LAF Chaise
- 2 - Item #1206 EL RAF Sofa



LUXHOME
SEATING

ELLINGTON 1300 COLLECTION



FEATURES

Drop-in Coil Spring System
Semi-Attached Fiber Filled Backs with Zipper
High Resilience 2.6 Density Seat Foam
Removable Tapered Legs
Soft Edge Seating

CUSTOM OPTIONS

Softer Seat Foam (no upcharge)
Firmer Seat Foam (no upcharge)
Foam Insert for Backs (upcharge, see price list)
Nail Heads (upcharge, see page 63 for options)

WOOD LEGS

Available in Brown Maple or Oak
(see page 64 for stain color options)

*Braxton Recliner Shown in Kodiak Leather and Brown Maple with FC 11047 Ebony,
Sofa/Chair Shown in C29-9 Breakfast Fabric and Oak with OCS 104 Seely*



ELLINGTON SOFA TRACK ARM



*Shown in C29-9 Breakfast Fabric
and Oak with OCS 104 Seely*

DIMENSIONS

	Width	Depth	Height	Inside Width	Seat Height	Seat Depth	Arm Height
1303 EL Ellington Sofa Track Arm <i>(shown)</i>	80	38	38	66	19	21	25
1304 EL Ellington RAF Chair Track Arm	29	38	38	22	19	21	25
1305 EL Ellington RAF Loveseat Track Arm	51	38	38	44	19	21	25
1306 EL Ellington RAF Sofa Track Arm	73	38	38	66	19	21	25
1307 EL Ellington LAF Chair Track Arm	29	38	38	22	19	21	25
1308 EL Ellington LAF Loveseat Track Arm	51	38	38	44	19	21	25
1309 EL Ellington LAF Sofa Track Arm	73	38	38	66	19	21	25
1310 EL Ellington RAF Chaise Track Arm	29	67	38	22	19	51	25
1311 EL Ellington LAF Chaise Track Arm	29	67	38	22	19	51	25
1312 EL Ellington RAF Corner Sofa Track Arm	89	38	38	65	19	21	25
1313 EL Ellington LAF Corner Sofa Track Arm	89	38	38	65	19	21	25
1314 EL Ellington Corner Seat	38	38	38	22	19	21	-
1315 EL Ellington Armless Chair	22	38	38	22	19	21	-
1316 EL Ellington Armless Loveseat	44	38	38	44	19	21	-
1317 EL Ellington Armless Sofa	66	38	38	66	19	21	-

ELLINGTON LOVESEAT TRACK ARM



Shown in C29-9 Breakfast Fabric and Brown Maple with FC 11047 Ebony

ELLINGTON CHAIR TRACK ARM



Shown in C29-9 Breakfast Fabric and Oak with OCS 104 Seely

DIMENSIONS

	Width	Depth	Height	Inside Width	Seat Height	Seat Depth	Arm Height
1302 EL Ellington Loveseat Track Arm	58	38	38	44	19	21	25
1301 EL Ellington Chair Track Arm	36	38	38	22	19	21	25
1318 EL Ellington Chair 1/2 Track Arm <i>(not shown)</i>	46	38	38	22	19	21	25

ELLINGTON 26" FOOTSTOOL



Shown in Rum Leather (left) and Texas Leather (above/right) and Brown Maple with FC 11047 Ebony

DIMENSIONS	Width	Depth	Height	Inside Width	Seat Height	Seat Depth	Arm Height
1126 EL Ellington 26" Footstool	26	24	16	-	-	-	-
1136 EL Ellington 36" Footstool (not shown)	36	24	16	-	-	-	-

ELLINGTON 1300 AVAILABLE PIECES

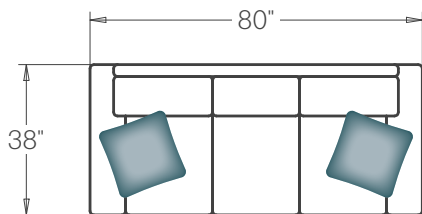

**Item #1303 EL
Sofa**

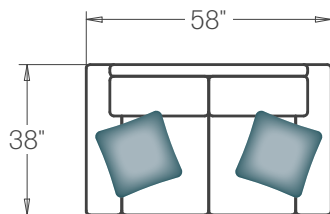

**Item #1302 EL
Loveseat**

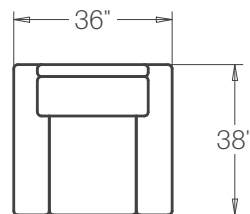

**Item #1301 EL
Chair**

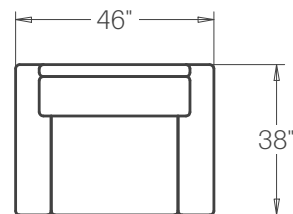

**Item #1318 EL
Chair 1/2**

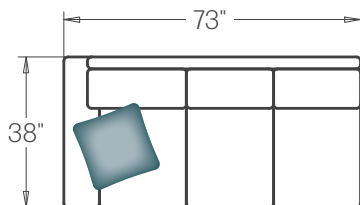

**Item #1309 EL
LAF Sofa**

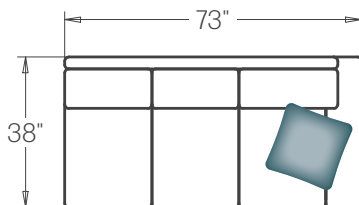

**Item #1306 EL
RAF Sofa**

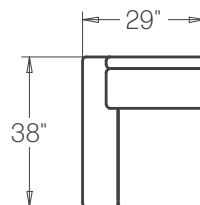

**Item #1307 EL
LAF Chair**

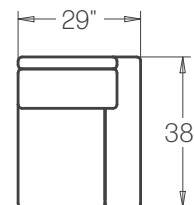

**Item #1304 EL
RAF Chair**

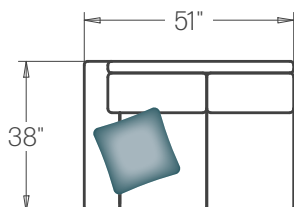

**Item #1308 EL
LAF Loveseat**

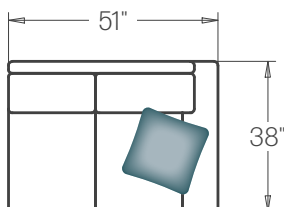

**Item #1305 EL
RAF Loveseat**

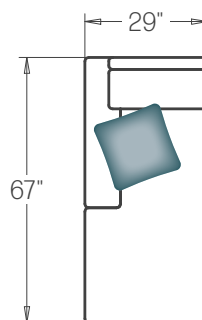

**Item #1311 EL
LAF Chaise**

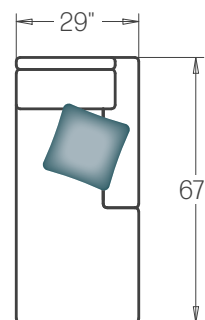

**Item #1310 EL
RAF Chaise**

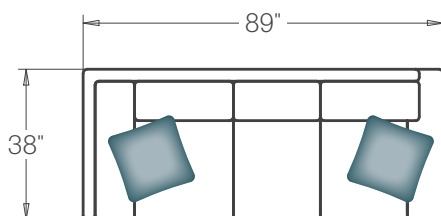

**Item #1312 EL
RAF Corner Sofa**

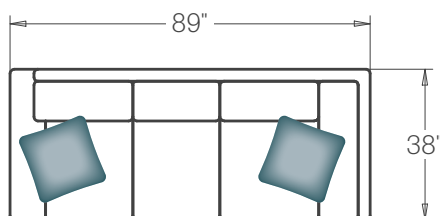

**Item #1313 EL
LAF Corner Sofa**

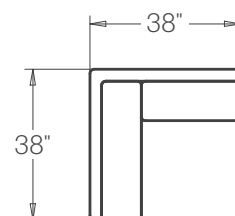

**Item #1314 EL
Corner Seat**

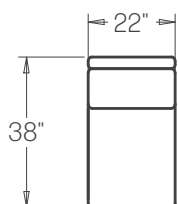

**Item #1315 EL
Armless Chair**

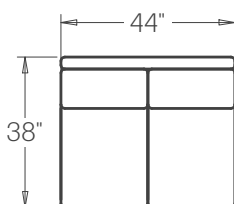

**Item #1316 EL
Armless Loveseat**

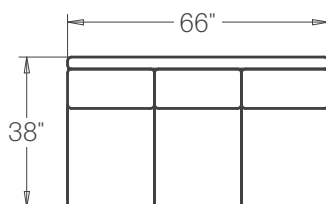

**Item #1317 EL
Armless Sofa**

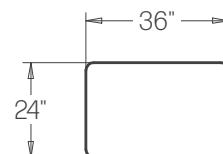

**Item #1136 EL
36 inch Footstool**

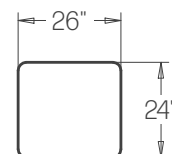

**Item #1126 EL
26 inch Footstool**

ELLINGTON 1300 SECTIONAL EXAMPLES

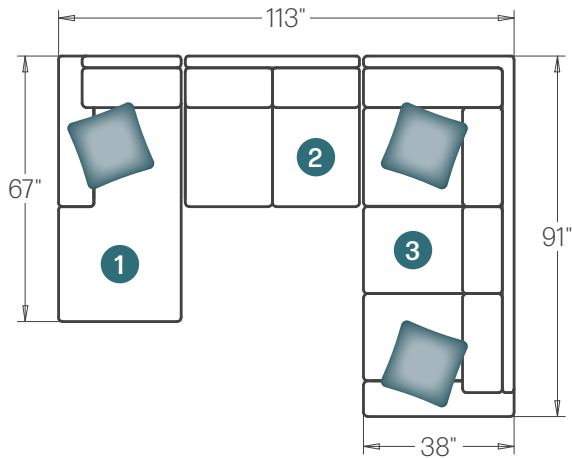

- 1 - Item #1311 EL LAF Chaise
- 2 - Item #1316 EL Armless Loveseat
- 3 - Item #1312 EL RAF Corner Sofa

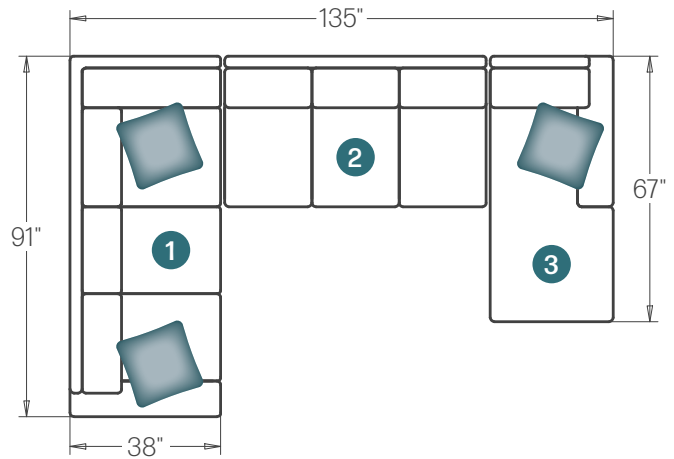

- 1 - Item #1313 EL LAF Corner Sofa
- 2 - Item #1317 EL Armless Sofa
- 3 - Item #1310 EL RAF Chaise

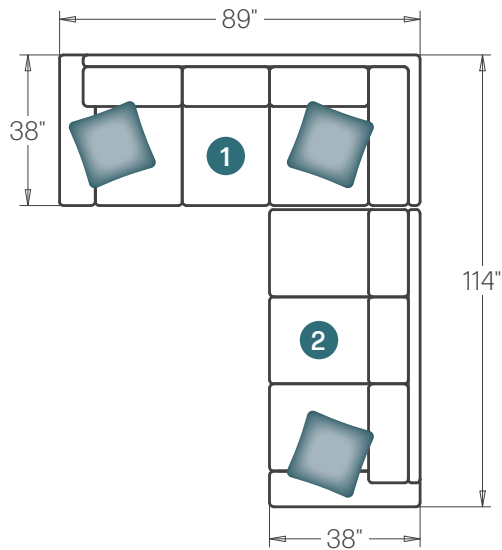

- 1 - Item #1313 EL LAF Corner Sofa
- 2 - Item #1306 EL RAF Sofa

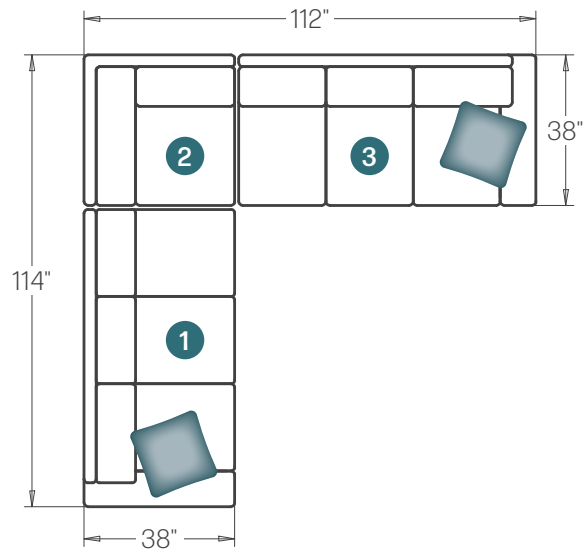

- 1 - Item #1309 EL LAF Sofa
- 2 - Item #1314 EL Corner Seat
- 3 - Item #1306 EL RAF Sofa

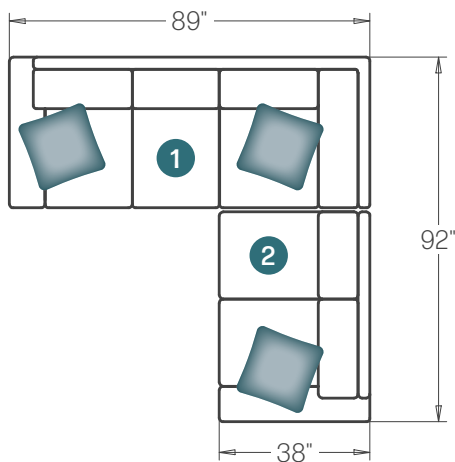

- 1 - Item #1313 EL LAF Corner Sofa
- 2 - Item #1308 EL LAF Loveseat

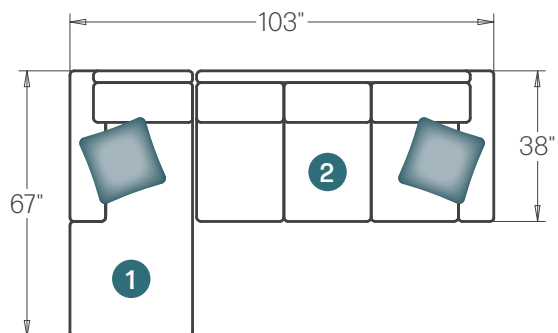

- 1 - Item #1311 EL LAF Chaise
- 2 - Item #1306 EL RAF Sofa



LUXHOME
SEATING

HARMONY COLLECTION



FEATURES

Drop-in Coil Spring System
High Resilience 2.6 Density Seat Foam
Removable Tapered Legs
Foam Backs

POWER OPTION



Available on All Harmony Products Except for the Swivel Glider Recliner and Swivel Rocker Recliner

CUSTOM OPTIONS

Softer Seat Foam (no upcharge)
Firmer Seat Foam (no upcharge)
Battery Pack (upcharge, see price list)

WOOD LEGS

Available in Brown Maple or Oak
(see page 64 for stain color options)

*Push Back Recliner Shown in R1-105 Black Fabric,
WH 5-Piece Sectional Shown in 7-83 Copper Fabric
and Brown Maple with FC 11047 Ebony*



HARMONY WH 6-PIECE SECTIONAL



Shown in 7-83 Copper Fabric and Brown Maple with FC 11047 Ebony

DIMENSIONS

	Width	Depth	Height	Inside Width	Seat Height	Seat Depth	Arm Height
31HY6PS Harmony WH 6-Piece Sectional	101 x 126	37	40 ½	63 x 88	19 ½	20	23 ½

WH = Wall Hugger

HARMONY WH 5-PIECE SECTIONAL



Shown in 7-83 Copper Fabric and Brown Maple with FC 11047 Ebony

DIMENSIONS

	Width	Depth	Height	Inside Width	Seat Height	Seat Depth	Arm Height
30 HY5PS Harmony WH 5-Piece Sectional	101 x 101	37	40 ½	63 x 63	19 ½	20	23 ½

HARMONY WH SOFA RECLINER



Shown in 7-83 Copper Fabric and Brown Maple with FC 11047 Ebony

DIMENSIONS

	Width	Depth	Height	Inside Width	Seat Height	Seat Depth	Arm Height
26 HYSR Harmony WH Sofa Recliner	85	37	40 ½	75	19 ½	20	23 ½

WH = Wall Hugger • Note: Both Ends of Sofa Recline, Middle is Stationary

HARMONY WH LOVESEAT RECLINER



Shown in 7-83 Copper Fabric and Brown Maple with FC 11047 Ebony

DIMENSIONS	Width	Depth	Height	Inside Width	Seat Height	Seat Depth	Arm Height
25 HYLRL Harmony WH Loveseat Recliner	60	37	40 ½	50	19 ½	20	23 ½

HARMONY WH RECLINER W/POWER OPTION



Shown in 7-83 Copper Fabric and Brown Maple with FC 11047 Ebony

DIMENSIONS

	Width	Depth	Height	Inside Width	Seat Height	Seat Depth	Arm Height
24 HYCR Harmony WH Recliner	35	37	40 ½	25	19 ½	20	23 ½

WH = Wall Hugger

HARMONY PUSH BACK RECLINER



Shown in R1-105 Black Fabric and Brown Maple with FC 11047 Ebony

DIMENSIONS

	Width	Depth	Height	Inside Width	Seat Height	Seat Depth	Arm Height
23 HYR Harmony Push Back Recliner	32	38	42 ½	22 ½	19	20	25

HARMONY ROCKER RECLINER



Shown in R1-105 Black Fabric

DIMENSIONS

	Width	Depth	Height	Inside Width	Seat Height	Seat Depth	Arm Height
21HYRR Harmony Rocker Recliner	33	38	40 ½	23	19 ½	20	25

HARMONY SWIVEL GLIDER RECLINER



Shown in R1-105 Black Fabric

DIMENSIONS

	Width	Depth	Height	Inside Width	Seat Height	Seat Depth	Arm Height
20 HYGRS Harmony Swivel Glider Recliner	33	38	40 ½	23	19 ½	20	25

HARMONY SWIVEL ROCKER RECLINER



Shown in R1-105 Black Fabric

DIMENSIONS

	Width	Depth	Height	Inside Width	Seat Height	Seat Depth	Arm Height
22 HYRRS Harmony Swivel Rocker Recliner	33	38	41 ½	23	20 ½	20	26

HUDSON RECLINER



HUDSON FEATURES

- Push Back Recline
- Drop-in Coil Spring System
- Bustle Back
- High Resilience 2.6 Density Seat Foam
- Built-in Tapered Legs (non-removable)

CUSTOM OPTIONS

- Softer Seat Foam (no upcharge)
- Firmer Seat Foam (no upcharge)
- Battery Pack (upcharge, see price list)
- Power Option (upcharge, see price list)



WOOD LEGS

Available in Brown Maple or Oak
(see page 64 for stain color options)



*Shown in C29-9 Breakfast Fabric and
Brown Maple with FC 11047 Ebony*

DIMENSIONS	Width	Depth	Height	Inside Width	Seat Height	Seat Depth	Arm Height	Full Recline Length	Wall Clearance
510 HR Hudson Recliner	34	40	43	22	21	19	25 ½	70	18

HUDSON RECLINER W/POWER OPTION



Shown in Vanilla Leather and Brown Maple with FC 11047 Ebony

DIMENSIONS									
	Width	Depth	Height	Inside Width	Seat Height	Seat Depth	Arm Height	Full Recline Length	Wall Clearance
510 HR Hudson Recliner	34	40	43	22	21	19	25 ½	70	18



LUXHOME
SEATING

REMINGTON COLLECTION



FEATURES

- Drop-in Coil Spring System
- Bustle Backs
- High Resilience 2.6 Density Seat Foam
- Removable Tapered Legs
- Zero Wall Motorized Reclining with Tilt Headrest



Only Available in Power,
Switch Located on
Inside of Arm

CUSTOM OPTIONS

- Softer Seat Foam (no upcharge)
- Firmer Seat Foam (no upcharge)
- Battery Pack (upcharge, see price list)

WOOD LEGS

Available in Brown Maple or Oak
(see page 64 for stain color options)

Note: Minimum of 36" Wide Door for Delivery

*Chair Shown in Forest Leather, Sofa/Loveseat Shown in
C2-5 Harvest Fabric and Brown Maple with FC 11047 Ebony*



REMINGTON PWR SOFA RECLINER W/TILT HEADREST



Shown in C2-5 Harvest Fabric and Brown Maple with FC 11047 Ebony



With the touch of a button, you can power up to the perfect position, customized for your personal TV viewing preference, or adjust your headrest for a comfy, luxurious – and well deserved – catnap.

DIMENSIONS									
	Width	Depth	Height	Inside Width	Seat Height	Seat Depth	Arm Height	Full Recline Length	Wall Clearance
5103 RM Remington PWR Sofa Recliner w/Headrest	87	43	41	72	20 ½	21 ½	24 ½	68	0

REMINGTON PWR LOVESEAT RECLINER W/TILT HEADREST



Shown in C2-5 Harvest Fabric and Brown Maple with FC 11047 Ebony

DIMENSIONS										
	Width	Depth	Height	Inside Width	Seat Height	Seat Depth	Arm Height	Full Recline Length	Wall Clearance	
5102 RM Remington PWR Loveseat Recliner w/Headrest	63	43	41	48	20 ½	21 ½	24 ½	68	0	

REMINGTON PWR CHAIR RECLINER W/TILT HEADREST



Shown in Forest Leather and
 Brown Maple with FC 11047 Ebony

DIMENSIONS									
	Width	Depth	Height	Inside Width	Seat Height	Seat Depth	Arm Height	Full Recline Length	Wall Clearance
5101 RM Remington PWR Chair Recliner w/Headrest	39	43	41	24	20 ½	21 ½	24 ½	68	0



LUXHOME
SEATING

SERENE COLLECTION



FEATURES

Drop-in Coil Spring System
High Resilience 2.6 Density Seat Foam
Removable Round Tapered Legs
Foam Backs

CUSTOM OPTIONS

Softer Seat Foam (no upcharge)
Firmer Seat Foam (no upcharge)

WOOD LEGS

Available in Brown Maple or Oak
(see page 64 for stain color options)



FULLY MODULAR

- Select Arm Style (FA Flat Arm or TDA Tear Drop Arm)
- Select Wood Leg Species
- Select Wood Leg Stain
- Select Extra Seat Unit if You Need Additional Seating Configuration

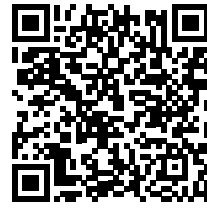

**EDUCATIONAL
VIDEO**



**ASSEMBLY
MANUAL**

Q&A

Q: The catalog says that I can't order any pattern match fabric, does that mean I can't order fabric with patterns on it?

A: You can order fabric that has patterns on it, but we won't be able to match the patterns from one seat to the next.

Q: How do I order a 4+ seat sofa?

A: Start with the 3-seat sofa and order the Serene extra seat unit for as many seats as you want to add.

Q: How do I order a 4-seat sectional instead of the listed 5-seat sectional?

A: Order the 4-seat sectional and deduct the price of a Serene extra seat unit to get the correct pricing.

Q: How do I order a 5+ seat sectional instead of the listed 5-seat sectional?

A: Start with the 5-seat sectional and order the Serene extra seat unit for as many seats as you want to add.

Q: How do I order a U sectional that gets more than 1 corner seat?

A: Please contact us for a quote.

Q: Will I get 1 less seat cushion for the sofa if I order a sofa and a chaise together since the chaise comes with 1 long cushion?

A: No, the chaise is an "add on option" so you will always get a complete set of whatever you order with the chaise, which will then allow you to add or remove the chaise whenever you need.

REVERSIBLE CUSHIONS



SERENE 5-SEAT SECTIONAL FLAT ARM



SERENE 5-SEAT SECTIONAL TEAR DROP ARM



Shown in C16-11 Astrid Fabric and Brown Maple with FC 11047 Ebony

DIMENSIONS	Width	Depth	Height	Inside Width	Seat Height	Seat Depth	Arm Height
13 S5SS-FA Serene 5-Seat Sectional Flat Arm	88 - 88	34	32	71 - 71	17 ½	21	24
17 S5SS-TDA Serene 5-Seat Sect. Tear Drop Arm	88 - 88	34	32	71 - 71	17 ½	21	26 - 26

SERENE SOFA FLAT ARM



SERENE SOFA TEAR DROP ARM



Shown in C16-11 Astrid Fabric and Brown Maple with FC 11047 Ebony

DIMENSIONS	Width	Depth	Height	Inside Width	Seat Height	Seat Depth	Arm Height
12 SS-FA Serene Sofa Flat Arm	85	34	32	75	17 ½	21	24
16 SS-TDA Serene Sofa Tear Drop Arm	82	34	32	75	17 ½	21	25 - 26

SERENE LOVESEAT FLAT ARM



SERENE LOVESEAT TEAR DROP ARM



Shown in C16-11 Astrid Fabric and Brown Maple with FC 11047 Ebony

DIMENSIONS	Width	Depth	Height	Inside Width	Seat Height	Seat Depth	Arm Height
11 SL-FA Serene Loveseat Flat Arm	60	34	32	50	17 ½	21	24
15 SL-TDA Serene Loveseat Tear Drop Arm	60	34	32	50	17 ½	21	24 - 26

SERENE CHAIR FLAT ARM



SERENE CHAIR TEAR DROP ARM



Shown in C16-11 Astrid Fabric and Brown Maple with FC 11047 Ebony

DIMENSIONS	Width	Depth	Height	Inside Width	Seat Height	Seat Depth	Arm Height
10 SC-FA Serene Chair Flat Arm	35	34	32	25	17 ½	21	24
14 SC-TDA Serene Chair Tear Drop Arm	35	34	32	25	17 ½	21	23 - 26

SERENE FOOTSTOOL



Shown in C16-11 Astrid Fabric and Brown Maple with FC 11047 Ebony

DIMENSIONS

	Width	Depth	Height	Inside Width	Seat Height	Seat Depth	Arm Height
19 SF Serene Footstool	25	25	17	-	-	-	-

SERENE CHAISE



Shown in 7-83 Copper Fabric and Brown Maple with FC 11047 Ebony

DIMENSIONS

	Width	Depth	Height	Inside Width	Seat Height	Seat Depth	Arm Height
--	-------	-------	--------	--------------	-------------	------------	------------

18 SCH Serene Chaise

25 25 17 ½ 25 17 ½ 46 -

SERENE EXTRA SEAT UNIT



Shown in C16-11 Astrid Fabric and Brown Maple with FC 11047 Ebony

DIMENSIONS

	Width	Depth	Height	Inside Width	Seat Height	Seat Depth	Arm Height
SESU Serene Extra Seat Unit	25	34	32	25	17 ½	21	-

SERENE AVAILABLE PIECES

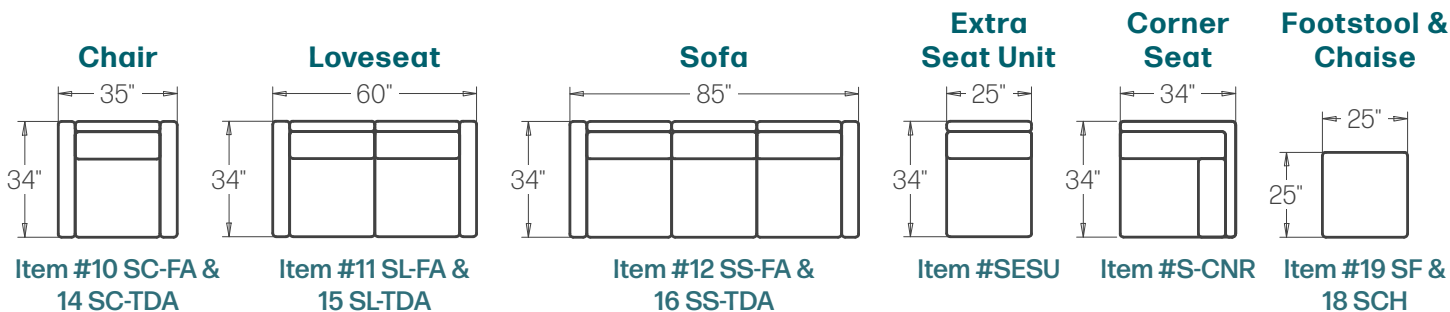

SECTIONAL SECTIONAL EXAMPLES

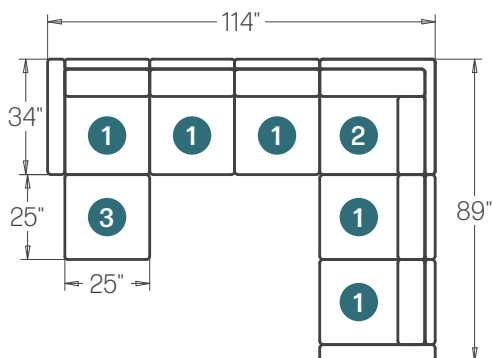

- 1 - Item #SESU Serene Extra Seat Unit
- 2 - Item #S-CNR Serene Corner Seat
- 3 - Item #18 SCH Serene Chaise

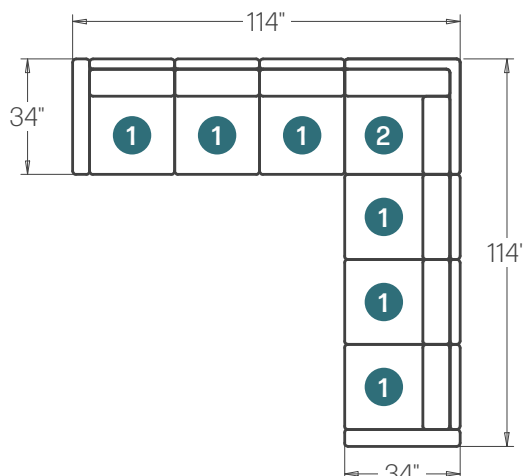

- 1 - Item #SESU Serene Extra Seat Unit
- 2 - Item #S-CNR Serene Corner Seat

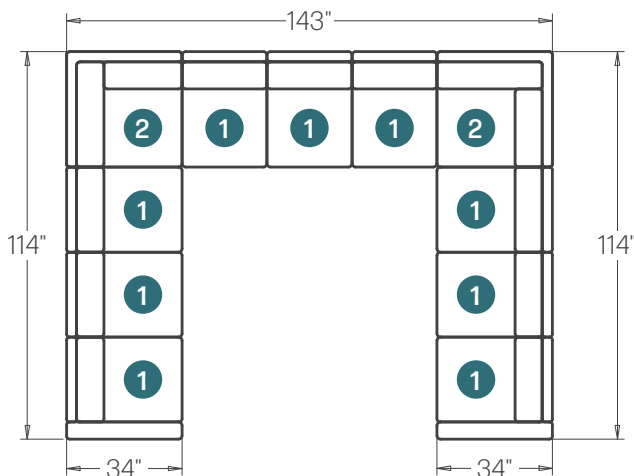

- 1 - Item #SESU Serene Extra Seat Unit
- 2 - Item #S-CNR Serene Corner Seat

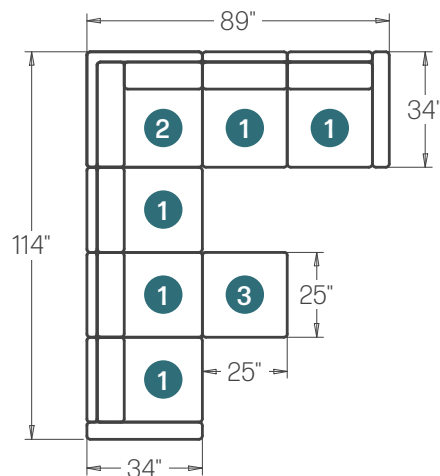

- 1 - Item #SESU Serene Extra Seat Unit
- 2 - Item #S-CNR Serene Corner Seat
- 3 - Item #18 SCH Serene Chaise

TATUM SWIVEL GLIDER RECLINER



TATUM FEATURES

- Drop-in Coil Spring System
- Bustle Back
- High Resilience 2.6 Density Seat Foam

CUSTOM OPTIONS

- Softer Seat Foam (no upcharge)
- Firmer Seat Foam (no upcharge)



Shown in R1-99 Hazelnut Fabric

DIMENSIONS	Width	Depth	Height	Inside Width	Seat Height	Seat Depth	Arm Height	Full Recline Length	Wall Clearance
515 TSGR Tatum Swivel Glider Recliner	33	40	42	23	22	18	26	68	15

TATUM SWIVEL ROCKER RECLINER



Shown in R1-99 Hazelnut Fabric

DIMENSIONS	Width	Depth	Height	Inside Width	Seat Height	Seat Depth	Arm Height	Full Recline Length	Wall Clearance
517 TSRR Tatum Swivel Rocker Recliner	33	40	43	23	23	18	26	66	15

TATUM ROCKER RECLINER W/POWER OPTION



TATUM FEATURES

- Drop-in Coil Spring System
- Bustle Back
- High Resilience 2.6 Density Seat Foam

CUSTOM OPTIONS

- Softer Seat Foam (no upcharge)
- Firmer Seat Foam (no upcharge)
- Power Option Only Available on Rocker (upcharge, see price list)



Shown in Night Sky Leather

DIMENSIONS	Width	Depth	Height	Inside Width	Seat Height	Seat Depth	Arm Height	Full Recline Length	Wall Clearance
516 TRR Tatum Rocker Recliner	33	40	42	23	22	18	26	66	15

PILLOWS

Decorative accent pillows are available to be ordered individually in the sizes below. All accent pillows come standard with welt, but can be ordered "weltless" at no charge. Please specify on order.



18" x 18" Large Pillow



13" x 13" Small Pillow.



7" x 20" Bolster Pillow

NAIL HEADS



Sock Arm and Track Arm nail heads will only be applied on the bottom of the front rail.



Black Nickel



Dull Black



Old Brass



Old Gold Z



Pewter

BROWN MAPLE STAIN COLORS



Natural



Almond (FC 42000)



Sealy (FC 44938)



Michael's Cherry



Driftwood (FC 11434)



Earthtone (FC 40592)



Acres (D22R00973)



Ebony (FC 11047)

OAK STAIN COLORS



Natural



Almond (FC 42000)



Sealy (FC 44938)



Michael's Cherry



Driftwood (FC 11434)



Earthtone (FC 40592)



Acres (D22R00973)



Ebony (FC 11047)

FABRICS & LEATHERS

Heartland Fabrics, LLC

**Wholesale Distributors of
Quality Fabrics, Leather & Suedes**

- Over 400 In-Stock Fabrics
- Genuine Full Hide Leathers
- Faux Leathers
- Micro Suedes
(Water Resistant)
- Crypton® Home Fabric
Easy Clean – Durable – Odor Resistant
- Revolution
Performance Fabric
Stain Resistant
- Indoor and Outdoor
Performance Fabric
Stain Resistant
- Full Rolls / Cut Yardage

Servicing furniture builders, upholstery shops, & buggy shops



Conveniently located in Northern Indiana, call or write for more information. (Fax orders if possible.) Please include your business name and address.
5355W 400S • Topeka, IN 46571 • VM: (574) 642-1223 • Fax: (260) 593-4802

To view upholstery options visit heartland-fabrics.com

CARE & CLEANING GUIDE



Caring for fully upholstered furniture is essential to maintain its appearance and longevity.

GENERAL MAINTENANCE

- 1. Regular Vacuuming:** Dust mites, pet dander, and allergens accumulate over time. Vacuum your upholstered furniture at least once a month to remove surface dirt and debris. Use a clean, dry upholstery attachment or a stiff-bristle brush to loosen dried dirt and reach nooks and crannies.
- 2. Flip and rearrange loose cushions frequently:** This will help distribute the wear evenly.
- 3. Fluff throw pillows and loose or semi-attached backs frequently:** This will help them stay closer to their original shape.
- 4. Keep leather upholstery away from direct heat such as, fireplaces and air vents:** This can cause the leather to dry out and start cracking.
- 5. Avoid placing furniture in direct sunlight:** Place your upholstered furniture away from direct sunlight and heat sources. Sun exposure can fade fabrics, and excessive heat may damage them.

FABRIC CLEANING GUIDE

Standard Fabrics

Code WS: Spot clean with a mild solvent, an upholstery shampoo or the foam from a mild detergent.

Code S: Spot clean, using a mild water-free solvent or dry-cleaning product. Clean only in a well-ventilated room and avoid any product containing carbon tetrachloride or other toxic materials.

Code W: Spot clean, using the foam only from a water-based cleaning agent such as a mild detergent or non-solvent upholstery shampoo product. Apply foam with a soft brush in a circular motion. Vacuum when dry.

Performance Easy Clean Fabrics

Performance fabrics are easy to clean, but are not self-cleaning. Most spills will simply blot off the surface with a dry towel. And for more difficult stains, just follow these simple spot cleaning instructions

- Wipe away excess mess using a clean, dry towel
- Mix a simple soap and water solution*
- Apply and agitate with a soft bristle brush
- Blot with a clean towel
- Rinse thoroughly, and repeat if necessary

*We recommend mixing 1 tsp. enzyme laundry detergent, like Tide or Cheer, with 2 cups warm water. And remember, soap attracts dirt, so rinse thoroughly.

LEATHER CLEANING GUIDE

- Blot up spills immediately using a clean, white cloth
- Dust frequently with a soft, dry white cloth
- Clean regularly with a soft, white cloth that is lightly dampened with water. After wiping, gently rub with a soft dry cloth to remove soil.
- Never use polishes, oils, ammonia, cleaning fluids, solvents or detergents to clean. (The use of cleaning agents may cause damage and void the warranty.)

WARRANTY

Our consumer protection is our promise to you, the original purchaser, that each piece of LuxHome Seating products will be free from manufacturing defects for its useful life, provided the furniture is used in a residential application.

HARDWOOD FRAMES AND SPRINGS

LuxHome Seating warrants to you, the original retail purchaser, lifetime protection against manufacturing defects of frames and springs.

SEAT FOAM CORES

We fabricate our standard seating with (High Resilient 2.6 Density) polyurethane foam, which is considered the highest quality foam available to the upholstered furniture industry. LuxHome Seating warrants you the original retail purchaser, a lifetime warranty on our high resilient foam cores against any manufacturing defects for the lifetime of the product. The seat foam core refers only to the foam of the cushion, not the fiber wrap or the fabric or leather casing.

Note: Even though we use a high performing polyurethane foam, some flattening or loss of resiliency will occur as a result of normal use and aging. This is not covered under the warranty.

Cushion materials conform to the shape of the user and is not considered to be a manufacturing defect.

Cushion softness is significantly affected by the type of fabric or leather that surrounds it. Proper maintenance and seat cushion rotation where applicable will provide longer life and greater durability.

Cushions suspected to be defective must be returned to the builder for industry testing. If it is determined that the cores were not properly cared for or were under extreme abuse, would void the warranty. If found defective, LuxHome Seating will replace at no charge. Shipping and handling charges will apply to cushion cores replaced after two (2) years.

Blown Fiber Backs Note: Back cushions with blown fiber filling are exceptionally soft, but these fibers will show a loss of resilience as a result of normal use. LuxHome Seating cannot warrant blown-fiber back cushions against softening and flattening of fibers, which are considered normal wear, and not defects. The cushions should be fluffed occasionally to keep these fibers evenly distributed.

RECLINER MECHANISMS: (350LB LOAD RATING)

LuxHome Seating warrants to you the original purchaser, a limited three (3) year warranty for residential use only. In the event a mechanism is determined by LuxHome Seating to be defective within the warranty period, LuxHome Seating will, at its option, repair or replace the mechanism.

In no event shall LuxHome Seating be responsible for any disassembly, installation, or labor charges outside of our manufacturing facility. In addition, LuxHome Seating shall not be responsible for any shipping or packaging charges, except during the first year of this warranty.

FABRIC

LuxHome Seating warrants all fabrics for a period of one year to the extent of the warranty provided to LuxHome Seating by the original fabric supplier. In general, fabric manufacturers do not warrant for pilling, shading, fading, shrinkage, wrinkling, or stretching, so those properties are not covered under this warranty.

LEATHER

LuxHome Seating warrants all leathers for a period of one year to the extent of the warranty provided to LuxHome Seating by the original leather supplier. In general, leather manufacturers do not warrant for improper cleaning or contact damage, fading, shrinkage, wrinkling, or stretching, so those properties are not covered under this warranty. Leather is a natural product, so wrinkles, insect bites, healed scars and other natural markings, as well as some color and surface variations, are not considered flaws.

Exclusions: This warranty does not apply to furniture that is intentionally misused, or to damage resulting from negligence, exposure to sunlight or outdoor elements, nonresidential use, improper cleaning, pet damage, or other unreasonable use, or to fabric damage or failure due to a fabric protection chemical treatment, improper cleaning, or when abnormal heavy soiling or abuse is evident. This warranty applies only to the original purchaser and terminates in the event of resale or recover. Because LuxHome Seating is made by hand using natural materials, minor variations will occur from piece to piece. Therefore, this warranty does not cover such minor differences between your furniture and in-store samples, printed materials, and video or Internet displays.



LUXHOME
SEATING